

# I-10: Prince Road to 29th Street

I-10 Construction Zone and Traffic Flow: August 25, 2008

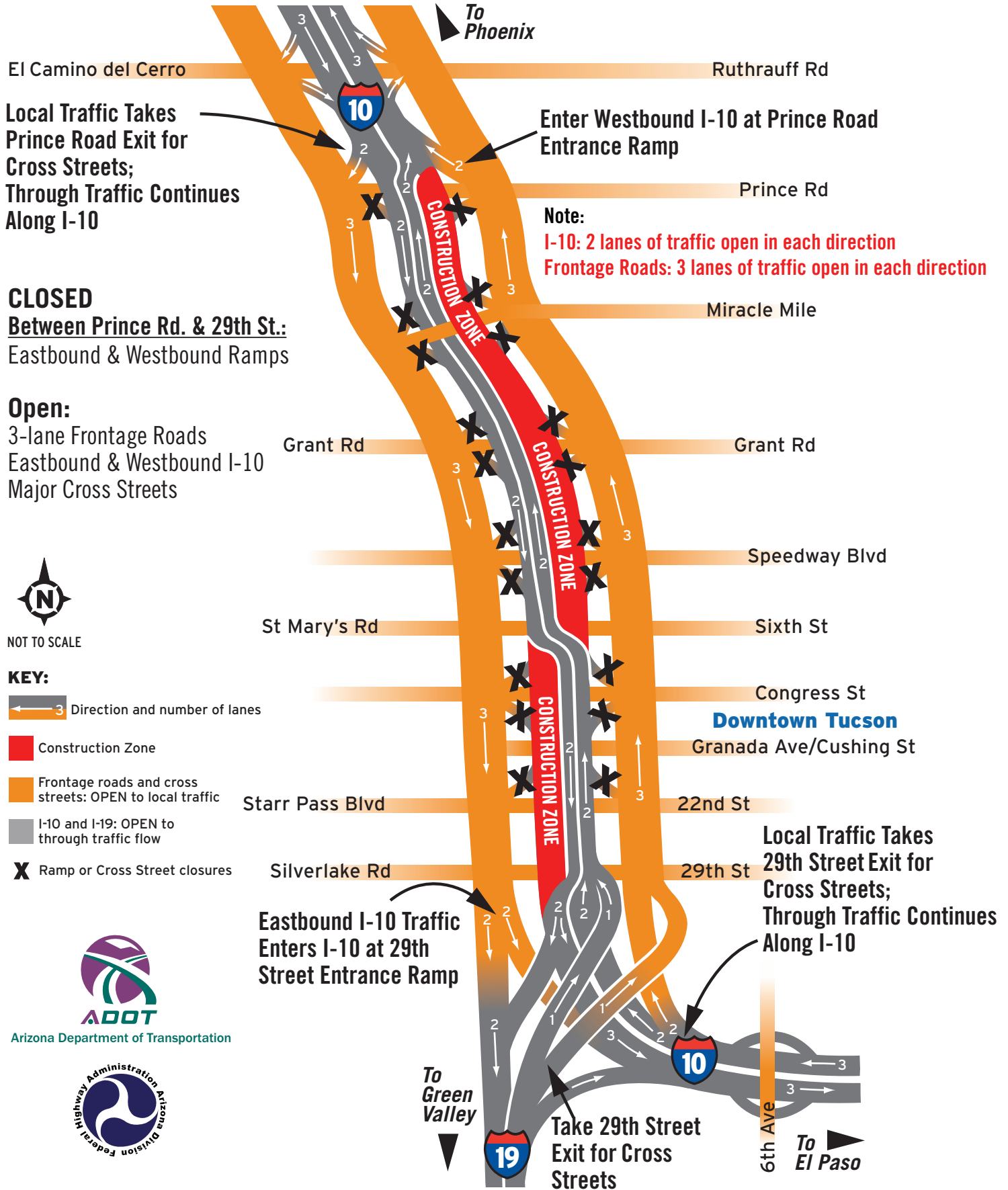

Local Traffic Takes Prince Road Exit for Cross Streets; Through Traffic Continues Along I-10

Enter Westbound I-10 at Prince Road Entrance Ramp

Note:  
I-10: 2 lanes of traffic open in each direction  
Frontage Roads: 3 lanes of traffic open in each direction

**CLOSED**  
Between Prince Rd. & 29th St.:  
Eastbound & Westbound Ramps

**Open:**  
3-lane Frontage Roads  
Eastbound & Westbound I-10  
Major Cross Streets



NOT TO SCALE

**KEY:**

- Direction and number of lanes
- Construction Zone
- Frontage roads and cross streets: OPEN to local traffic
- I-10 and I-19: OPEN to through traffic flow
- Ramp or Cross Street closures



Last revised: August 1, 2008

Note:  
Some ramps in this area are not shown in order to show local access as clearly as possible.